



# 510 HTC

## PROJECT

Galeon 510 Htc is set to debut as the sporty, twin model of the innovative 500 Fly.

Based on the same hull, the 510 Htc model will offer the same incredible interior layout and cutting-edge features

as the flybridge variant but with a little flair added to the mix. We made sure all passengers will enjoy a bright and welcoming atmosphere on board with the abundance of windows all around.

The unique feature of the hardtop comes over the helm station in form of a three part, immense sunroof ready to

lighten up the interior in a matter of seconds. Move over to the cockpit area to take advantage of the second glass sunroof and enjoy the sunshine without interruptions.

The distinctive, sporty presence of the 510 Htc is sure to impress all yachting enthusiasts.



The incredible, three part, glass roof over the helm



A glass roof over the cockpit is retractable



# 510 SKYDECK

PROJECT

Galeon 510 will extend the range of Skydeck models, acclaimed for their incredible design and innovative features.

Sharing the new hull with the 500 Fly, the Skydeck will offer an amazing amount of interior space on all decks - a

staple of all Galeon third generation yachts. With broad windows all around, the passengers will enjoy a bright and welcoming atmosphere on the main deck as well as down below.

What sets the Skydeck models apart from other yachts is their ability to combine the advantages of having a top deck with the distinct, sporty look of a hardtop. The Gale-

on 510 will also feature a full-sized sunroof over the helm and an automatic soft roof to cover the deck when necessary.

Experience the power of innovation and the intense character of the upcoming 510 Skydeck!



Set up the port side bar in to impress your guests



The bow area can quickly transform into a sundeck

Galeon 510 Htc has an aggressive and dynamic design

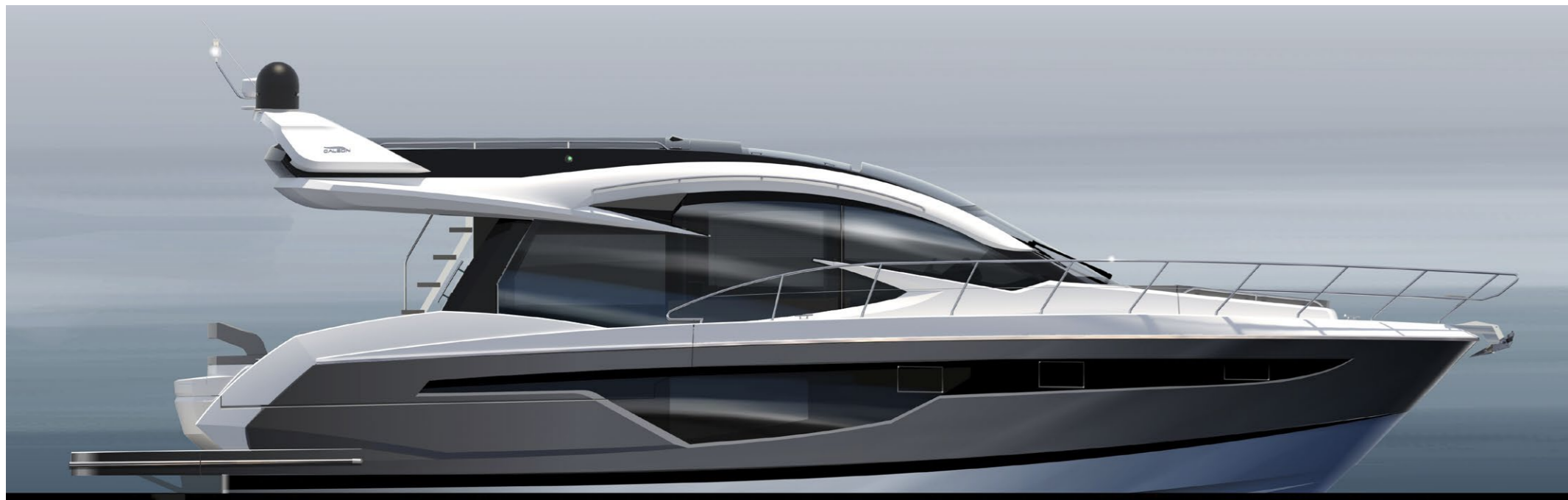
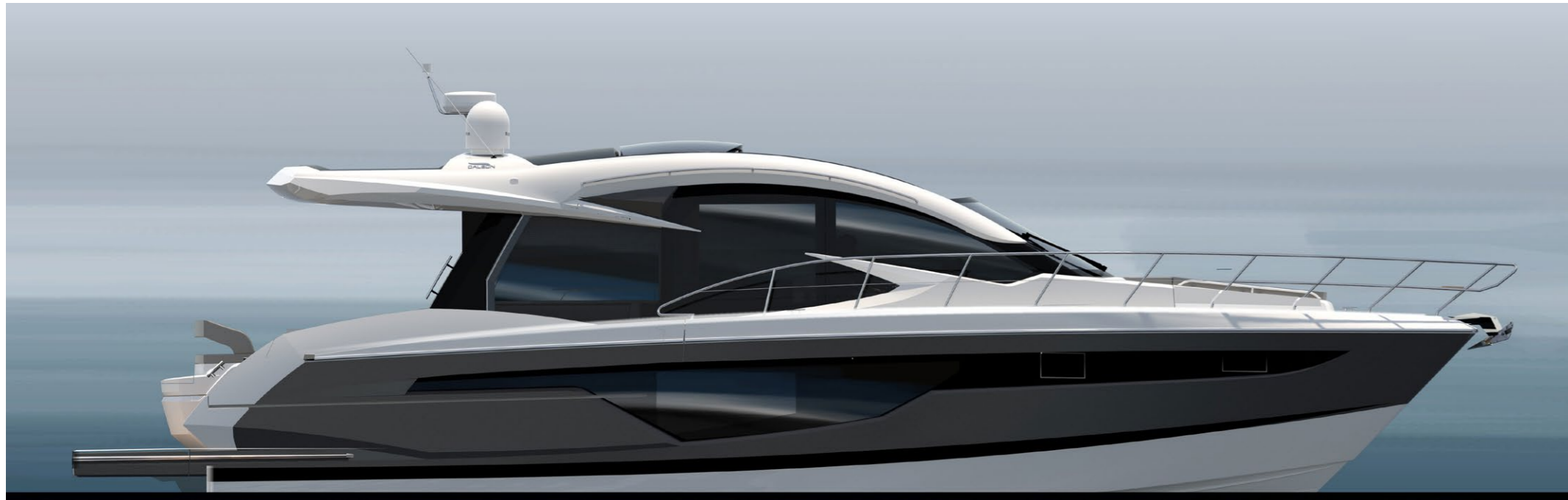

Galeon 510 Skydeck offers a sleek profile and a hidden top deck

# 510<sup>HTC</sup> & 510<sup>SKYDECK</sup>

## LAYOUTS

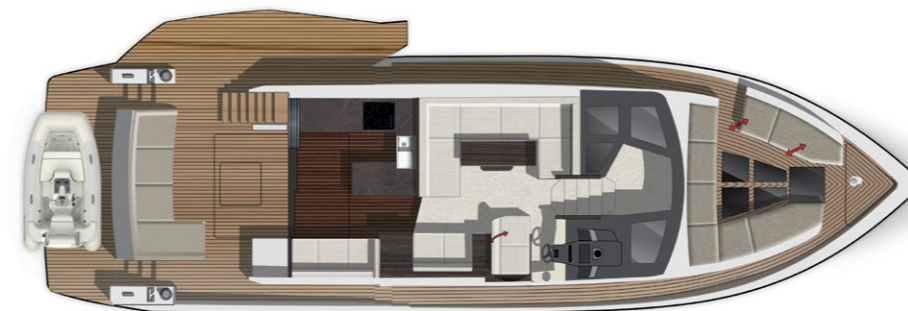

## TECHNICAL SPECIFICATION

Length of the hull	[m] 14,44	[ft] 47'5"
Length overall	[m] 16,20	[ft] 53'2"
Beam of the hull	[m] 4,40	[ft] 14'5"
Beam overall	[m] 4,46 / 6,00	[ft] 14'8" / 19'8"
Draft max. (canoe body)	[m] 1,00	[ft] 3'3"
Fuel tank capacity	[dm <sup>3</sup> ] 2 x 900	[US Gal] 2 x 198
Water tank capacity	[dm <sup>3</sup> ] 650	[US Gal] 143
Mass of Light Craft Condition	[kg] 22750	[lbs] 50155
Maximum Load	[kg] 4270	[lbs] 9413
Min. engine (-s) power	[kW/HP] 2 x 429 / 575	
Max. engine (-s) power	[kW/HP] 2 x 540 / 725	
Crew limit	12	
Category	B	

All data values are estimated

**3<sup>RD</sup> GALEON**  
GENERATION

**CASTRO**  
DESIGN

**VOLVO**  
PENTA